



**TWDQ30060**

2 WAY-180° Power splitter

1 ~ 750MHz

**V1**

## Features:

- RoHS Compliant
- Tape & Reel
- 260 Degree Cel SMT Process

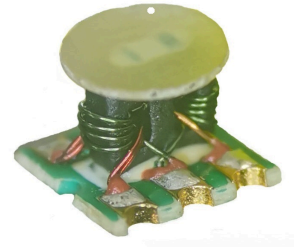

## Schematic:

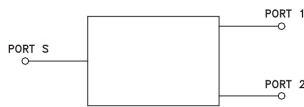

## Ports Configuration:

<b>SUM PORT</b>	<b>6</b>
<b>PORT1</b>	<b>1</b>
<b>PORT2</b>	<b>3</b>
<b>GROUND</b>	<b>2,4</b>

## Maximum Ratings:

Parameters	Conditions	Unit	Min	Max
RF Power		Watt		1
DC Current		mA		500
Operating Temperature Range		Degree Cel	-40	85
Storage Temperature Range		Degree Cel	-55	100
Moisture Sensitivity Level				1

## Ordering Information:

Part Description	Details
TWDQ30060	2000 per reel
TWDQ30060-EVA	Evaluation Board for TWDQ30060

Electrical Specifications: Zo=50 Ohm Pin = 0 dBm

Parameter	Test Conditions	Unit	Min	Typical	Max
Frequency Range	-	MHz	1	~	750
Insertion Loss	1-750MHz	dB	-	1.4	1.8
Amplitude unbalance	1-750MHz	dB	-	0.5	0.9
Phase unbalance	1-750MHz	°	-10	2	10
Input VSWR	1-750MHz	VSWR	-	1.3	1.5
Output VSWR	1-750MHz	VSWR	-	1.5	1.8
Isolation	1-750MHz	dB	20	23	-

Notes:

- 1: Specifications guaranteed over the operating temperature range.
- 2: Touchstone format sNp file is available on [www.exploremw.com](http://www.exploremw.com).

Typical Performance Curves:

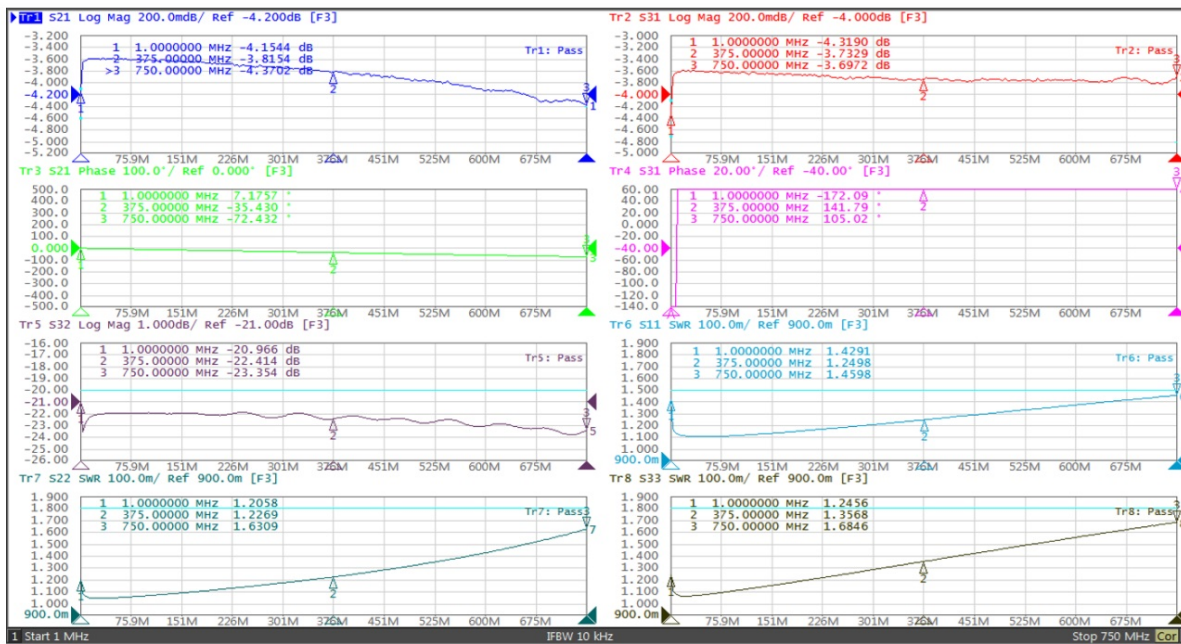

Mechanical Dimensions:

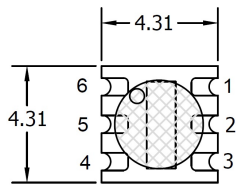

Top View

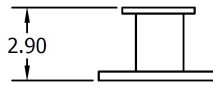

Side View

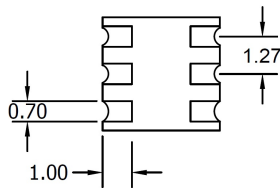

Bottom View

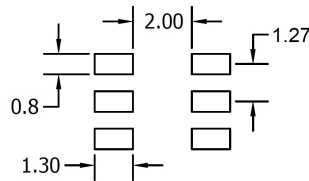

Suggested PCB Layout

Notes:

- 1: Dimensions in mm.
- 2: Tolerance  $\pm 0.3$ mm unless otherwise noted.
- 3: 3D model in STEP format is available at [www.exploremw.com](http://www.exploremw.com)